

# AS11S3 Biofilm Sensor



With hygienic connection to the process, flat surface in contact with the liquid and high resistance to chemical treatments, this model is indicated for applications where hygiene is critical

## Connection to the process

1" - 1 1/2" DIN 32676, ISO 2852

## Materials in contact with the process

Stainless Steel (working electrode ①, fitting ②), coated Titanium (counter electrode ③), PEEK ④

## Sensitivity

First bacterial layer

## Measures (mm)

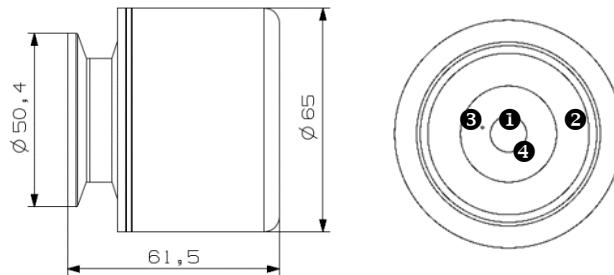

## Operating conditions

Temperature:

-10<T<+150 °C  
(to monitor biofilm growth: +2<T<+40 °C)

Oxygen:

>1 ppm

Pressure:

Determined by clamp

Conductivity:

>10 μS/cm

## Power supply

12 / 24 V DC ±20%, 500 mA

## Data communication

4-20 mA and RS485/MODBUS RTU

## Wiring

6-wire cable (external diam.<8 mm, wire section=0.5 mm<sup>2</sup>)  
2 wires used for power supply, 2 for RS485/MODBUS communication, 2 for 4-20 mA data transmission

## Software - Minimum system requirements (RS485/MODBUS)

PC with Windows XP/7/8/10, 1 GHz CPU, 512 Mb Ram, 200 Mb of free space on hard drive, RS485 serial interface or USB port (for USB-RS485/MODBUS converter)

Distributed by:  
**NELSON JAMESON**  
INC.  
800-826-8302 nelsonjameson.com